

Wonder-Gun NW501-L-20
NW501-LG-20 Specifications

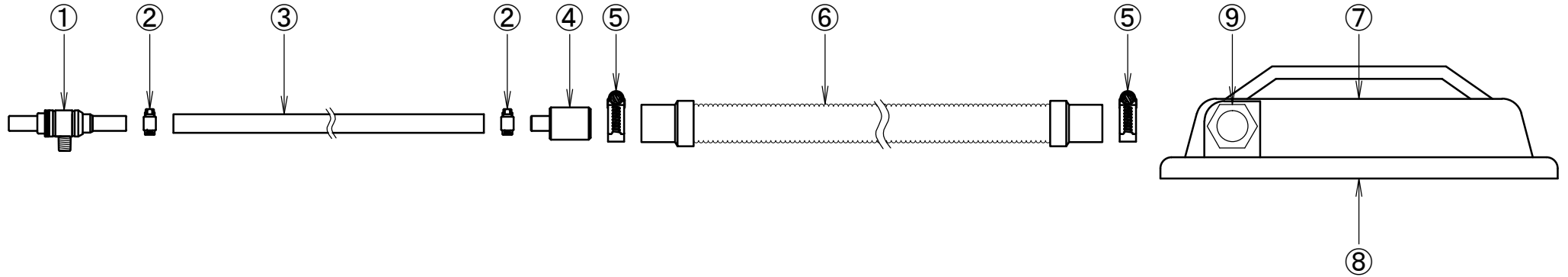

| | | |
|---------------|-----------------------------------|--|
| ⑨ | Metal fitting | Iron (Chromate conversion coating) OD ϕ 25 |
| ⑧ | Lid body | Iron casting Melamine resin baking finish (blue) |
| ⑦ | Lid top | Iron Perforated metal and Filter element |
| ⑥ | Duct hose | PVC ID ϕ 25 \times 2000mm (Cuffs on both sides) |
| ⑤ | Hose clamp (L) 2 piece | Iron (Chromate conversion coating) |
| ④ | Aluminum Sleeve | Aluminum \cdot A2011 |
| ③ | Polyethylene Hose | ϕ 15 \times ϕ 12 \times 500mm |
| ② | Hose clamp (S) 2 pieces | Stainless \cdot SUS304 |
| ① | NW501-L NW501-LG Wonder-Gun | Brass (Yellow chromate conversion coating) Minimum ID: ϕ 8 |
| | Name of article | Material \cdot Summaries |
| Customer: | | Issue Date |
| Description: | Drawn by: | |
| | Directed by: | |
| | Approval: | |
| Drawing date: | Scale: | Drawing Number |
| 2018/12/14 | -- | ESI-00205-3 |